



## Magnetic sensor 126

### Product characteristics

- Magnetic sensor on reed-contact basis
- Small housing for space-saving installation
- PA housing
- Ø6 x 30 mm
- PVC cable

### Technical drawing

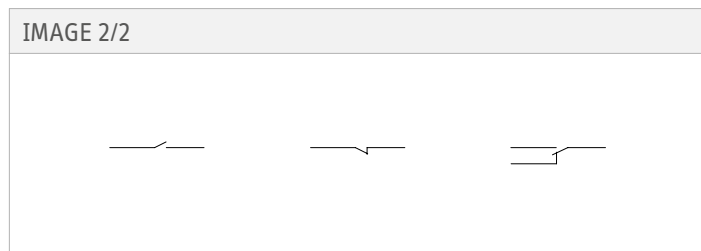
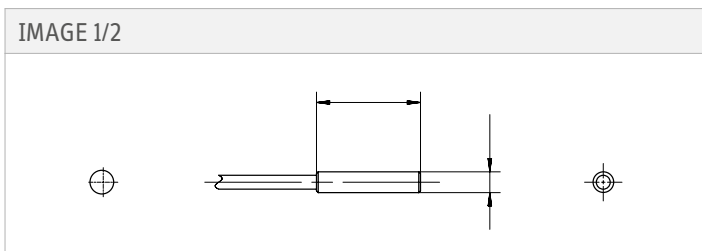

## Electrical data

Attribute	126210	126220	126230
Max. switching voltage	48 V DC	28 V DC	
Max. switching voltage	48 V AC	28 V AC	
Max. switching current	0.5 A	0.25 A	
Max. switching power	10 W	3 W	
Technology	Reed		
Contact form	NO	NC	CO
LED display	No		
Actuation	arbitrary		
Switching principle	magnetic		

## Mechanical data

Attribute	126210	126220	126230
Dimensions	D6 L=30		
Housing design	cylindrical		

## Material information

Attribute	126210	126220	126230
Housing material	PA6		
Cable material	PVC		

## Environmental conditions

Attribute	126210	126220	126230
Protection class	IP67 DIN EN 60529		
Operating temperature min.	-25 °C		
Max. operating temperature	75 °C		
Min. storage temperature	-25 °C		
Max. storage temperature	75 °C		
Min. cable temperature range, moving	-25 °C		-5 °C
Max. cable temperature range, moving	80 °C		70 °C
Min. cable temperature range, fixed installation	-40 °C		
Max. cable temperature range, fixed installation	80 °C		

## Installation

Attribute	126210	126220	126230
Mounting type	inserted		

## Connection

Attribute	126210	126220	126230
Cable length	1 m		