



Actuator for safety interlocks ZBA5GE

Technical specifications

- With insertion funnel
- Overrun 5 mm
- Material: stainless steel 1.4301, CR

Technical drawing

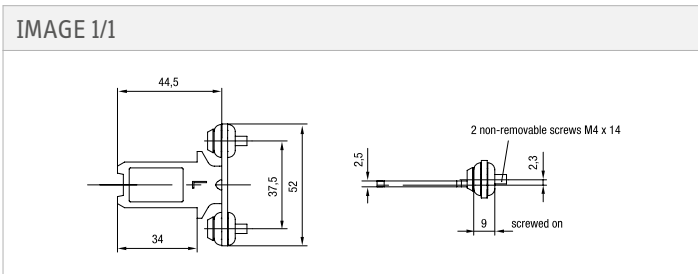

Mechanical data

Attribute	ZBA5GE
Dimensions	52 x 49,5 x 16 mm (H/B/T)
Tensile force max.	1500 N
Door radius min.	300 mm
Overrun max.	5 mm
Usability of insertion funnel	yes

Material information

Attribute	ZBA5GE
Housing material	Betaetiger/Schraube Stahl rostfrei Gummituelle NBR

Installation

Attribute	ZBA5GE
Mounting type	screwed
Installation	arbitrary